



QUENI
KOI

Queni Koi Ltd
Rectory Field Nursery
Wanlip Lane
Wanlip
Leicestershire
LE7 4PL

www.quenti-koi.co.uk - sales@quenti-koi.co.uk



QUICK GUIDE

v1.4

QK FILTER SYSTEMS



Index

1	BASIC REQUIREMENTS	3
1.1	Control unit	4
2	A. GRAVITY-SYSTEM	5
2.1	Placing the filter system.....	5
2.2	Set level control:	8
3	B. PUMP FED SYSTEM	9
3.1	Placing filter system.....	9
3.2	Set level control:	11

1 Basic requirements

Basic requirements every filter system must meet:

- The filter system should be placed on a ground surface with sufficient carrying capacity, for instance:
 - a well-vibrated sand bed of 10 cm, possibly with concrete tiles
 - a concrete floor

In the event of subsidence, the filter may not function properly!

- The filter system should be placed fully level.
- Leave sufficient space around the filter, to perform cleaning and maintenance work.

The filter system can be used as gravity-system or pump fed system.



IMPORTANT!

The correct placement and constant water level in the pond are important conditions for optimal and problem-free operation of the filter system.



IMPORTANT!

The use of salt in the pond can cause stainless steel components of the filter to oxidize.

1.1 Control unit

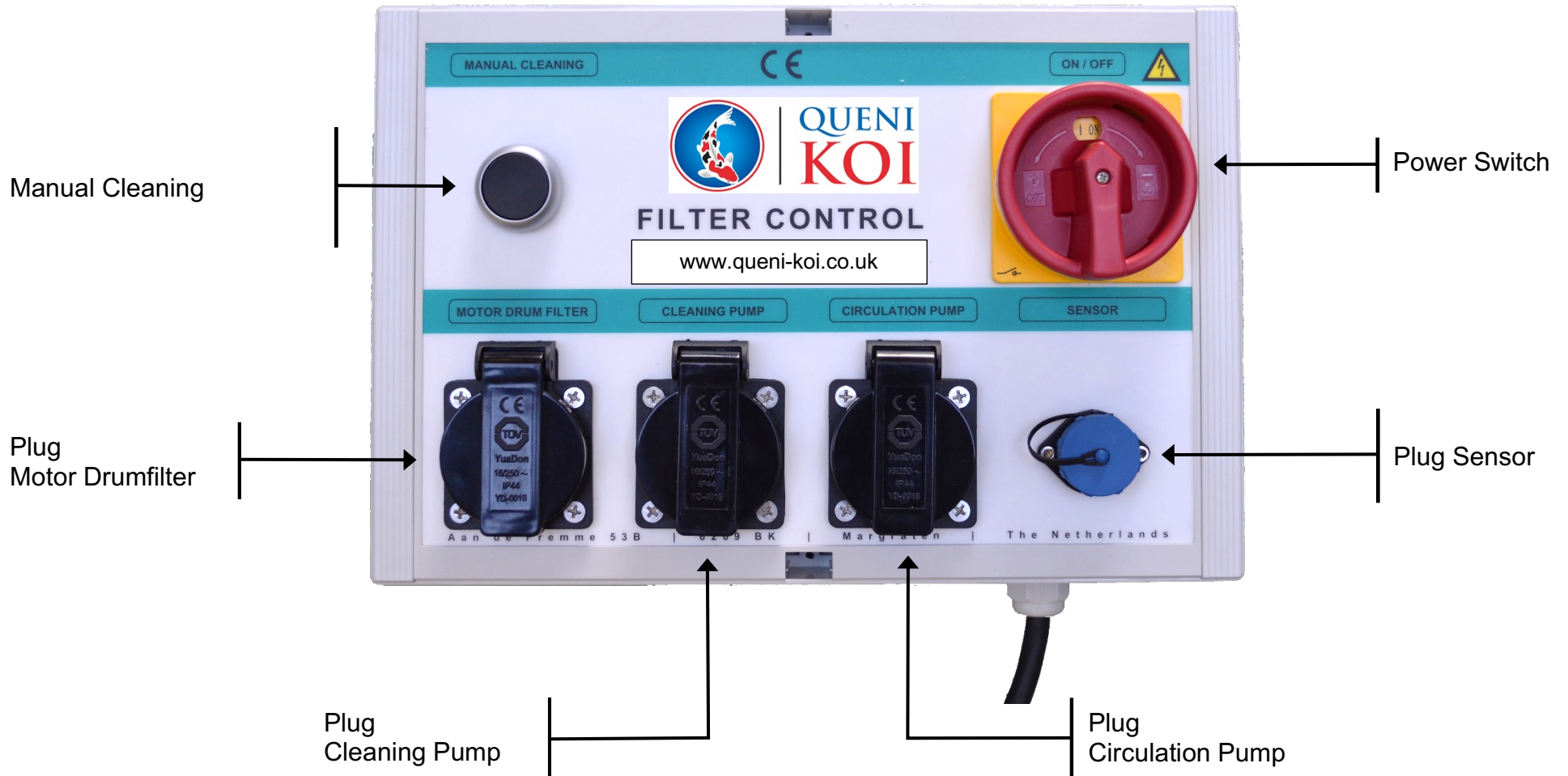

2 A. Gravity-system

2.1 *Placing the filter system*

- Determine the maximum water level of the pond.
- Align the base plate horizontally (the filter should be placed fully level).
- The filter should be placed the height of the installation height (fig. 2.1) above water level. (installation height is the distance from maximum water level to top of filter).

Type filter	Installation height [cm]
QKENTRY25	16
QK15	16
QK22	16
QK35	17
QK50	17
QK65	17
QK100	17
QK15 Combi	14
QK15 Combi	14
QK35 Combi	14
QK50 Combi	14
QK65 Combi	14



Schematic setup of the drum filter

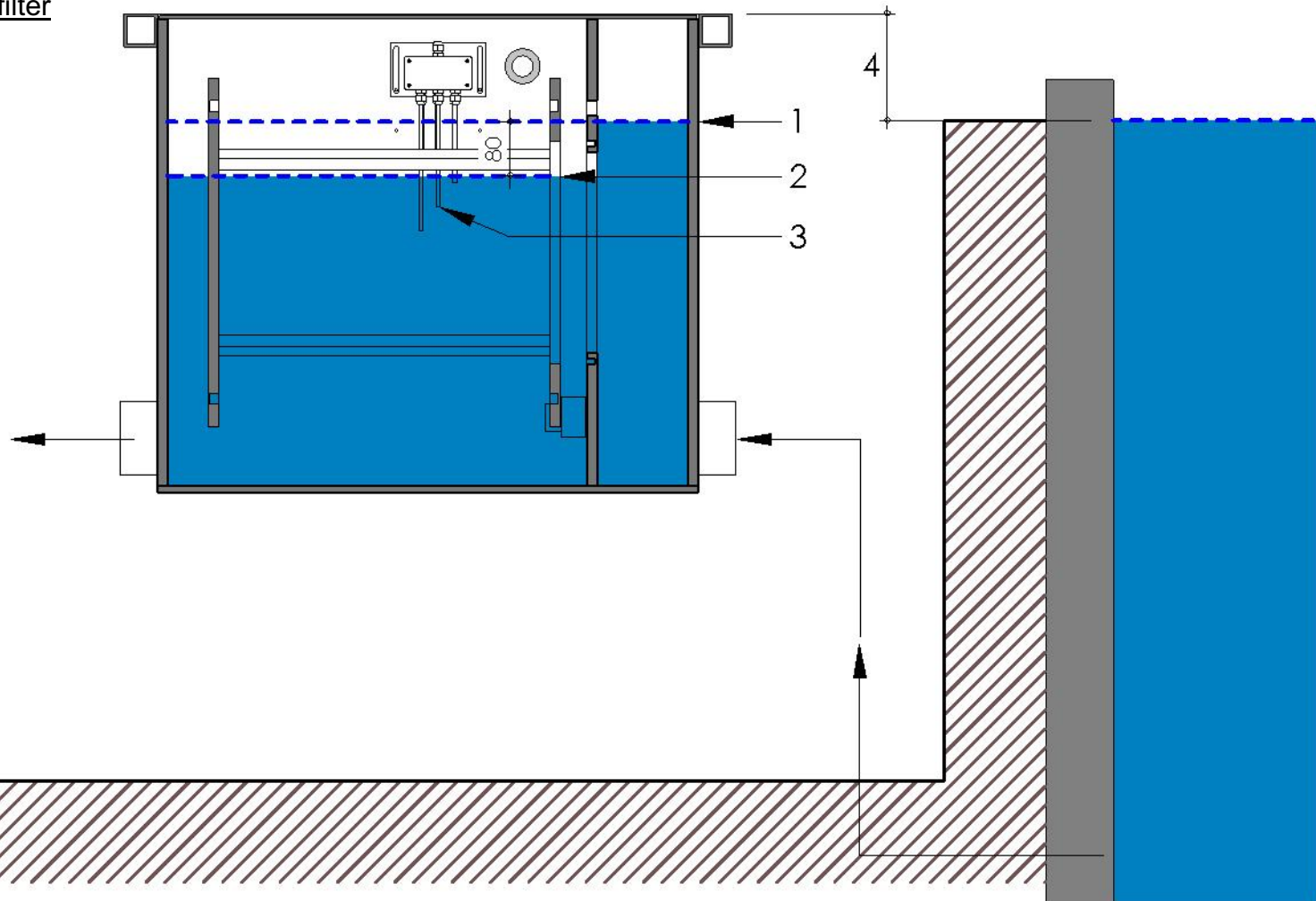

Pic. 2.1

1. Water level with running pump after rinse (short pen 8 cm in water)
2. Start rinsing
3. Pond pump switches off
4. Installation height QK15-65 is 17 cm

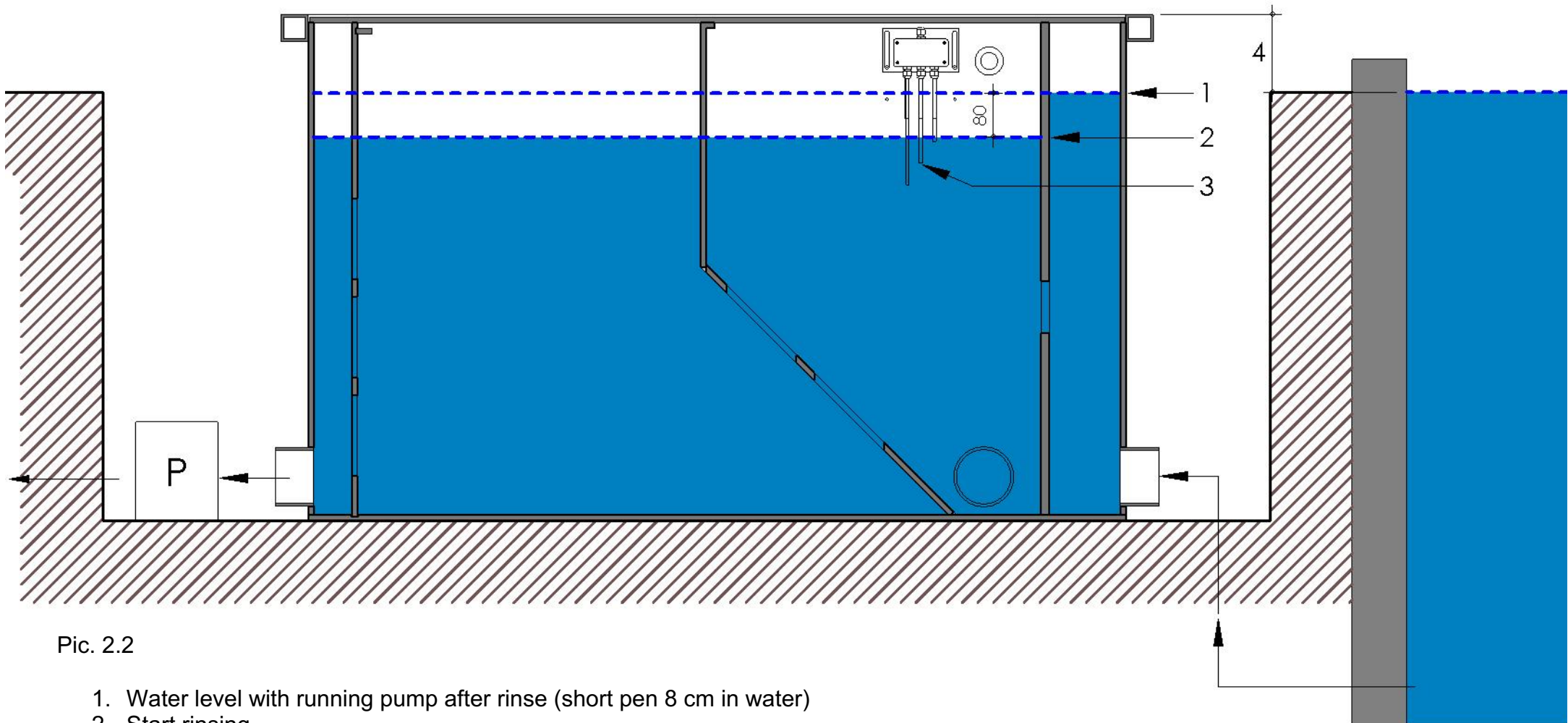
Schematic setup of the combi drum filter

Pic. 2.2

1. Water level with running pump after rinse (short pen 8 cm in water)
2. Start rinsing
3. Pond pump switches off
4. Installation height QK Combi's is 14 cm

2.2 Set level control:

- For the operation of the gravity system a constant water level in the pond is necessary. A tolerance of up to 20 mm below maximum water level is allowed.
- Should the maximum water level in the pond exceed this, the water excess water will be disposed of via the waste water drain, until the maximum water level has been reached

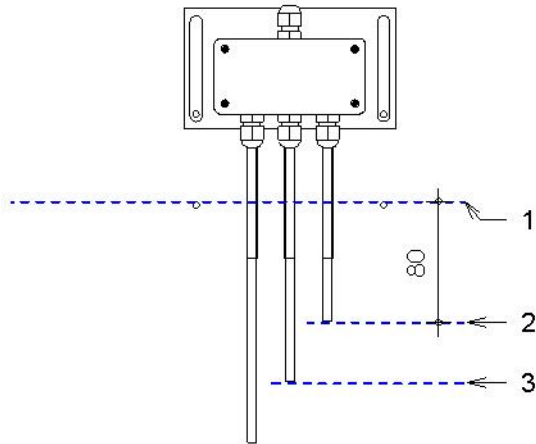

Pic. 2.3 Sensor

1. Water level with running pump after rinse (short pen 8 cm in water)
2. Start rinsing
3. Pondpump switches off

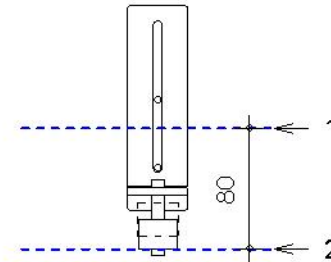

Pic. 2.4 Float switch (ECO models / models With PLC controller)

1. Water level with running pump after rinse
2. Start rinsing



3 B. Pump fed system

3.1 Placing filter system

- Determine the maximum water level of the pond
- Align the base plate horizontally (the filter should be completely level).
- The drumfilter must be placed 30cm higher than the biochamber.
(the distance from top of the drumfilter, to the top of the biochamber is 30cm)

Schematic setup of the drum filter

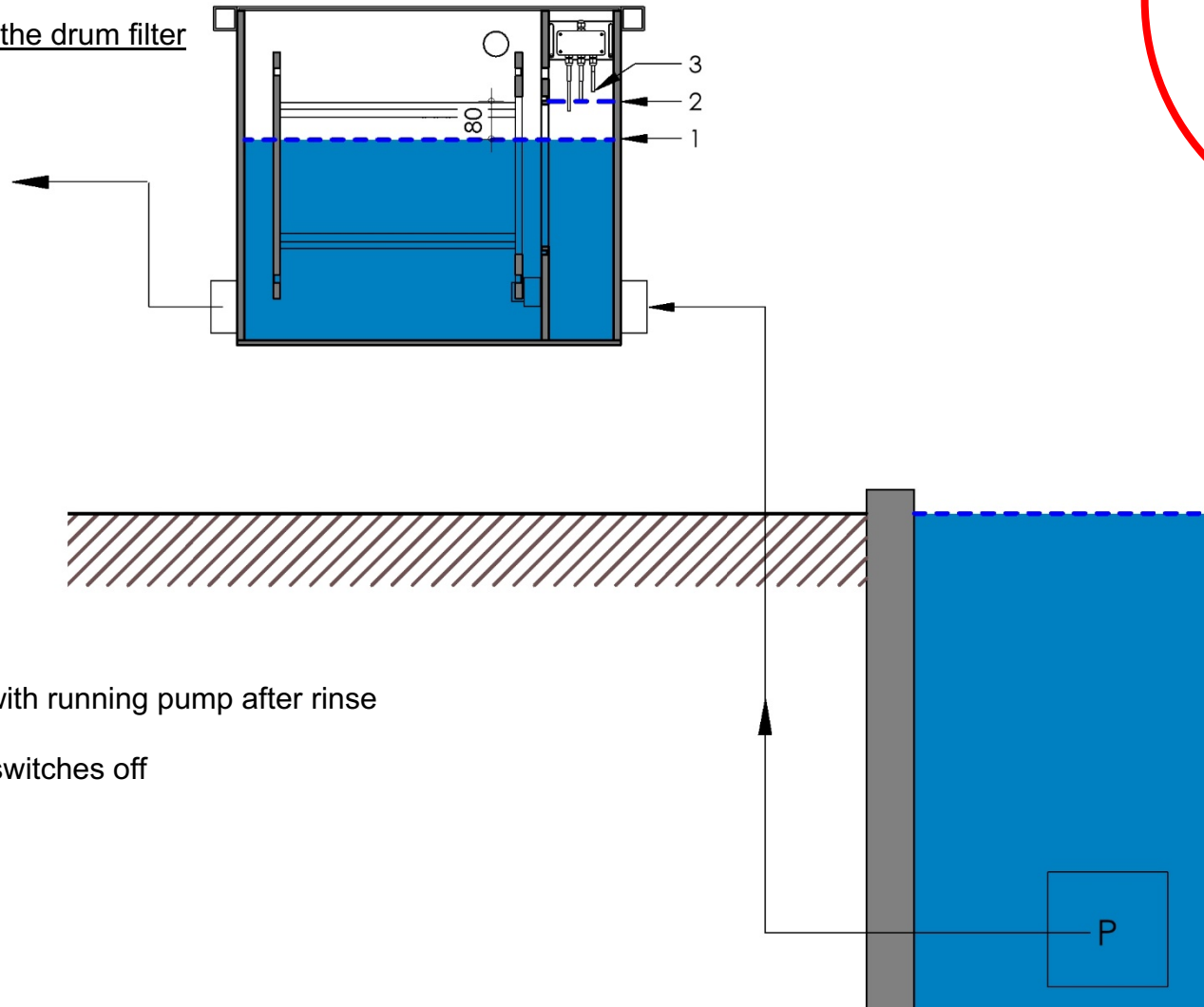

Pic. 3.1

1. Water level with running pump after rinse
2. Start rinsing
3. Pond pump switches off

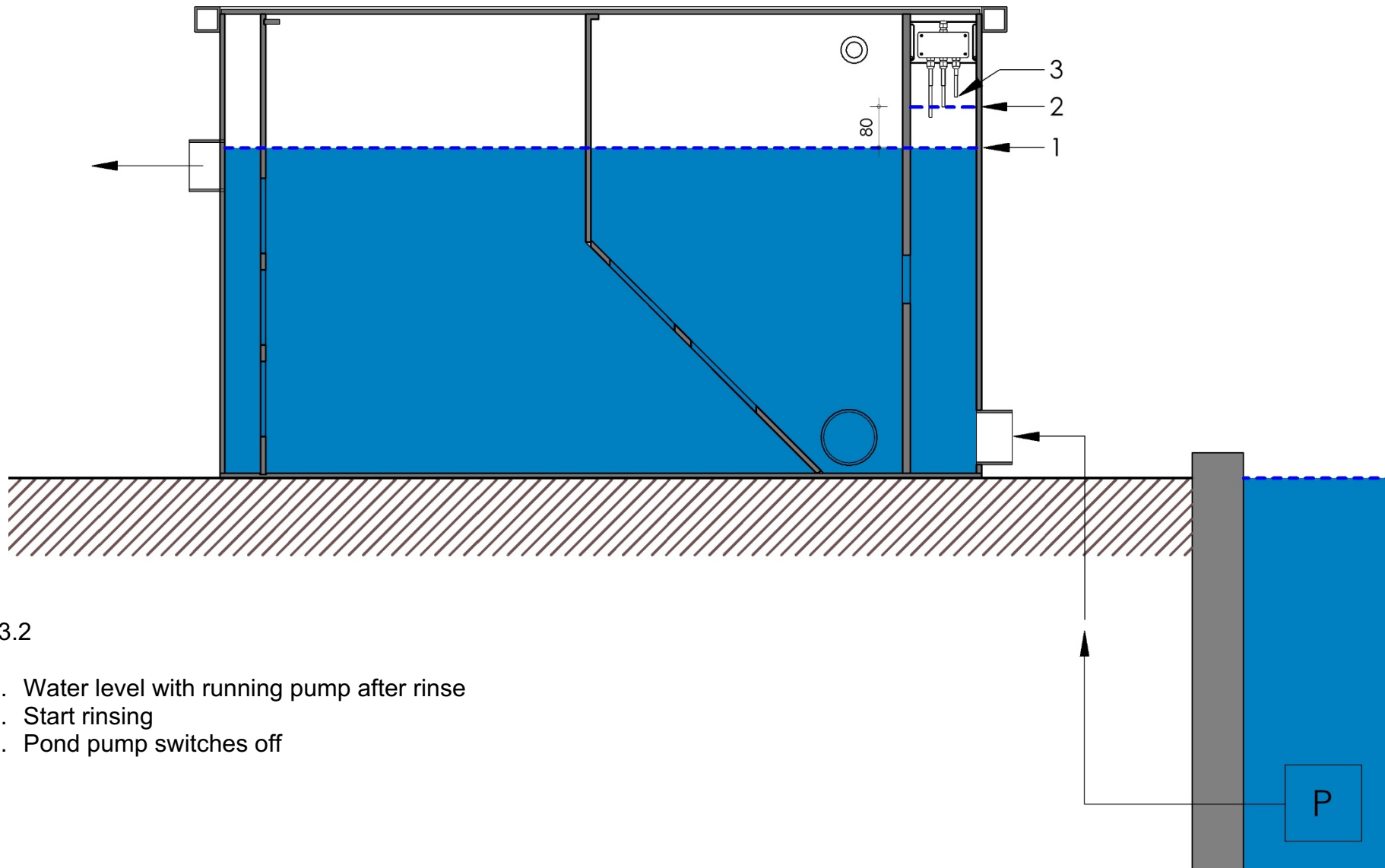
Schematic setup of the combi drum filter

Pic. 3.2

1. Water level with running pump after rinse
2. Start rinsing
3. Pond pump switches off

3.2 Set level control:

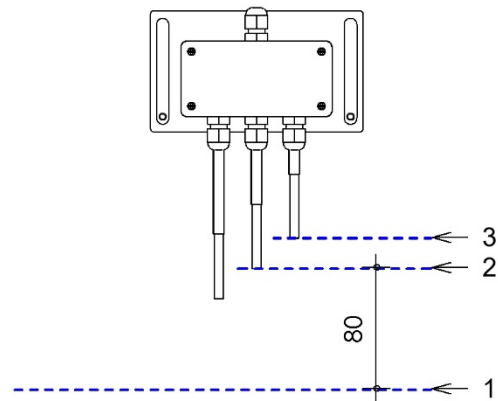

Pic. 3.3 Sensor

1. Water level with running pump after rinse
2. Start rinsing
3. Pond pump switches off

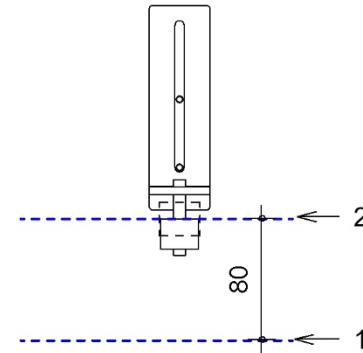

Pic. 3.4 Float switch (ECO models / models With PLC controller)

1. Water level with running pump after rinse
2. Start rinsing